

Car Refrigerator- W Series



WEG45/55/65

Scope of Application:

Cold chain transportation of samples, reagents, blood products, specimens and pharmaceuticals.

Innovative Design

- ◎ Pull Rod Design
- ◎ Ergonomic & User Friendly Design
- ◎ Low Voltage Battery Protection

Qingdao Haier Biomedical Co.,Ltd.

No.280 Feng Yuan Road, High-tech Zone,
Qingdao, 266109, P.R. China
E-mail: inquiry@haierbiomedical.com
Website: www.haiermedical.com



Haier Biomedical
International



Haier Biomedical
International



@haiermedicalint



Haier Biomedical
International



Haier Biomedical
International

Product Advantages



One unit for multiple applications

The power supply is equipped with a car cigarette lighter plug, AC 100-240V adapter and optional pluggable lithium battery, which is convenient for vehicle transport, long-term storage at home and outdoors use



Low sound level

Noise level less than 45 dB, providing a more comfortable environment



Anti-shake design

No fear of bumps



Low voltage battery protection

During vehicle use automatically detect battery power and power-off when the battery voltage is low to protect automobile battery



Double door double control series

Double chamber, but independent temperature control. Both compartment can be adjusted as a fridge or a freezer



Bluetooth connectivity (optional)

APP Bluetooth intelligent connection

Product Details



USB charging port

It can charge electronic devices such as mobile phones



Two LED lights

Light up immediately after opening, convenient for taking things at night



Embossed aluminum liner

Stable performance and rapid refrigeration

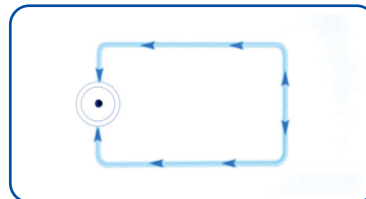

Outlet

It is convenient to clean the refrigerator and drain dirty water

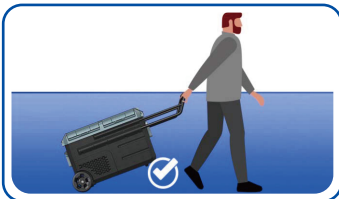

Design of portable pull rod for air circulation

Longer pull rod, won't touch the heel



Door body groove

Can hold mobile phones, iPads, etc



Double door design

Reversible door installation, dual door opening direction



Optional Bluetooth app

Remote temperature control, breaking the distance constraint

Product Dimension Drawings

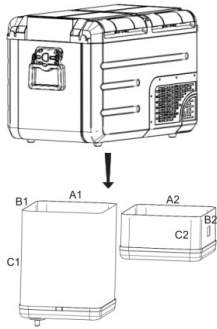

Model	Serial No.	A1/mm	B1/mm	C1/mm	A2/mm	B2/mm	C2/mm
WEG45		232	314	340	232	314	160
WEG55		232	314	424	232	314	244
WEG65		232	314	494	232	314	314

Specifications



Model	WEG45	WEG55	WEG65
Exterior Dimensions (mm)	750*449*455	750*449*525	750*449*595
Packing Dimensions (mm)	780*500*515	780*500*585	780*500*655
Net Weight (Kg)	16.5	17.5	18.5
Gross Weight (Kg)	19.5	20.5	21.5
Container Load (20')	136	136	102
Container Load (40'H)	360	288	288
Volume (L)	38 (Large: 25, Small: 13)	48 (Large: 30, Small: 18)	58 (Large: 35, Small: 23)
Ambient Temp. (°C)	10°C ~ +43 (SN/N/ST/T)	10°C~ +43°C (SN/N/ST/T)	10°C~ +43°C (SN/N/ST/T)
Cooling Type	Compressor	Compressor	Compressor
Refrigerant	R134a/50±0.5g	R134a/50±0.5g	R134a/60±0.5g
Thickness of Foaming Layer (mm)	45	45	45
Foaming Material	C5H10/C-Pentane	C5H10/C-Pentane	C5H10/C-Pentane
Temp. Range	-20°C ~ +10°C (@25°C)	-20°C ~ +10°C (@25°C)	-20°C~ +10°C (@25°C)
Voltage (V)	DC 12/24	DC 12/24	DC 12/24
Power of Adapter (V/Hz)	AC110-240, 50/60	AC110-240, 50/60	AC110-240, 50/60
Rated Power (W)	60	60	60
Noise Level (dB)	≤45	≤45	≤45
Working Mode	Direct cooling	Direct cooling	Direct cooling
Material of Shell	HDPE+PP	HDPE+PP	HDPE+PP
Power Consumption (kWh/24h)	0.23	0.23	0.23
Optional-Lithium Battery	187kwh,13000mAh	187kwh,13000mAh	187kwh,13000mAh
QTY of Blood Bags	Big space 48U	Small space 24U	Big space 72U
Dimension of Blood Bag: 140*110*25 (mm)			Small space 36U
			Big space 72U
			Small space 48U

*Haier Biomedical reserves the right to change products and specifications without prior notice.